

## Model VC01

# ***Valve Cartridge for the WeedSeeker<sup>®</sup> Sensor***

This Valve Cartridge is a high-speed encapsulated solenoid valve for water-based fluids, with a maximum flow rate of 0.4 GPM.

The cartridge consists of a 1/4" hose barb brass inlet, a spray nozzle, a nozzle cap, an LED indicator, a 3-pin electrical connector and 2 captive screws.

The cartridge snaps into the slot at the rear of the sensor.



## **Applications**

- ◆ Plant Counting & Mapping
- ◆ Flow/Volume Tracking
- ◆ Remote Indicator for Valve Actuation

# WeedSeeker® Valve Cartridge

## Specifications

900-1-005

### Electrical

Sink or Source current in DL output	10mA max
Current	80 mA

### Mechanical

Dimensions	2" x 2.25" x 4.5" (51 x 57 x 114 mm)
Weight	6.5 oz (186 g)
Flow Rate	0.4 gpm (Liquids only*) Std nozzle 6502 (0.2 gpm)

Compatible with all WeedSeeker sensors. Fluid path is brass fitting with viton seal.

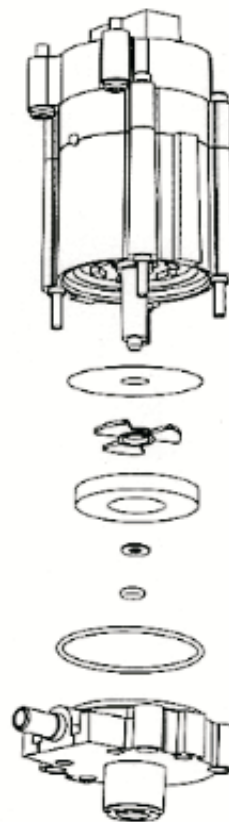

### Related Components

Maintenance Kit

Replacement screws, nozzles

\* Check with your chemical supplier

*The valve can handle most water-soluble chemicals. The use of wettable powders or other materials will cause solenoid to fail, and void warranty of cartridge.*

[www.ntechindustries.com](http://www.ntechindustries.com)

740 South State Street Ukiah, CA 95482  
707.467.3747 ph 707.467.3750 fax

888.728.2436

The logo for NTech Industries, Inc. features a stylized green plant icon to the left of the company name. The name "NTech" is in a large, bold, black font, and "Industries, Inc." is in a smaller, black font below it.